



GENUINE PARTS

INSTALLATION INSTRUCTIONS

1. DESCRIPTION: Titan Truck Bed Extender

2. APPLICATION: Titan King and Crew Cab truck with standard bed.

3. PART NUMBER: 999T7 WX290.

4. KIT CONTENTS:

<u>Item No.</u>	<u>Qty</u>	<u>Description</u>
1)	1	Right Bend Tube Assembly
2)	1	Left Bend Tube Assembly
3)	3	Extension Tube
4)	1	Bolt-On Bracket Set (LH and RH)
5)	6	PT Screw
6)	6	Double Wedge Threaded
7)	6	Double Wedge Thru-Hole

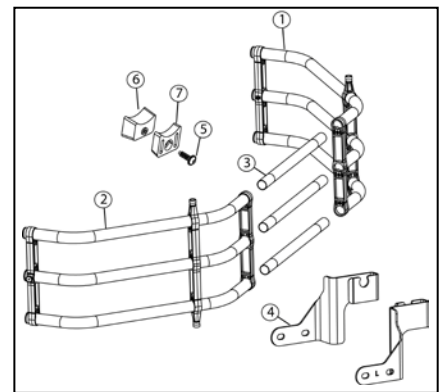

5. TOOLS REQUIRED:

- T-20 Torx Wrench
- Torque Wrench
- Tape Measure
- 12mm Wrench

6. INSTALLATION PRECAUTIONS / NOTES:

- 1) During the assembly and installation process, be careful not to scratch the surface.
- 2) Study illustrations and read the instructions carefully before attempting assembly.
- 3) Maximum load on open tailgate is 91Kg (200 lbs.)
- 4) Keep installation instructions in glove compartment for future reference.
- 5) Do not use bed extender or tailgate to secure cargo.

INSTALLATION INSTRUCTIONS – TITAN TRUCK BED EXTENDER

7. INSTALLATION PROCEDURE FOR BOLT-ON BRACKETS.

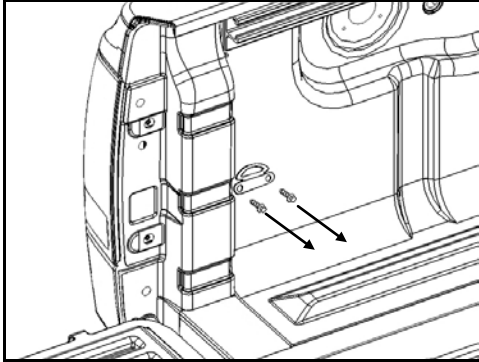

- 1) Remove the bolts that secure the tiedown hooks with a 12 mm wrench. **Do not** discard the bolts, retaining washers, and tiedown hooks.

Truck with drop-in bedliner, skip step 2.

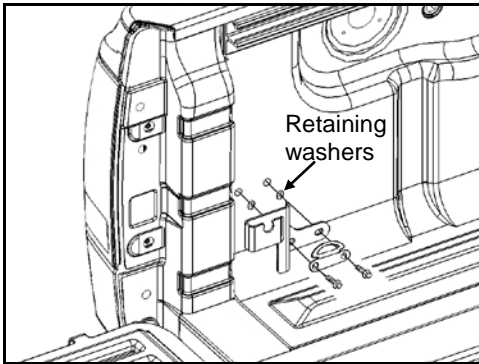

- 2) Re-install the Tie Down Hooks with the Bolt-On Brackets as shown in the figure. Tighten the bolts that were removed in previous step to 11-16 N-m (97-142 in-lbf.).

Truck without drop-in bedliner, skip step 3.

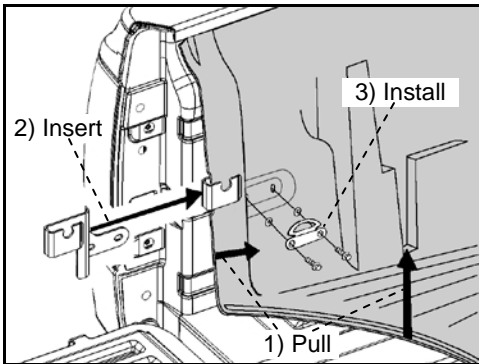

- 3) Pull the bedliner away enough from the truck bed sheet metal to insert the Bolt-On Brackets, and then re-install the Tie Down Hooks as shown in the figure. Tighten the bolts that were removed in previous step to 11-16 N-m (97-142 in-lbf.).

NOTE: The Bolt-On Brackets goes between the truck bed sheet metal and the bedliner.

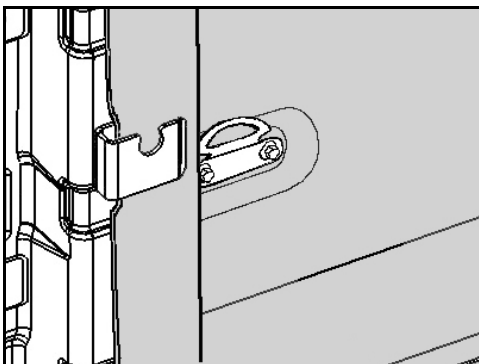

INSTALLATION INSTRUCTIONS – TITAN TRUCK BED EXTENDER

8. INSTALLATION PROCEDURE FOR BED EXTENDER.

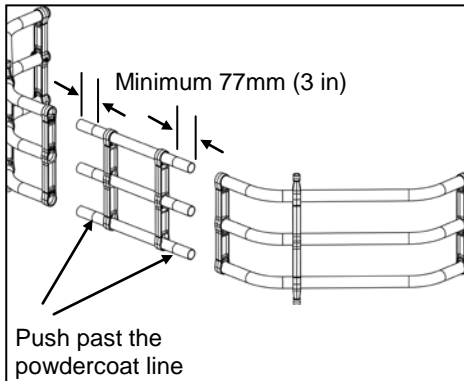

- 1) Slide the Extension Tubes evenly into the Left and Right Bent Tube Assembly.

NOTE: Make sure to slide the extension tubes into the bent tubes at minimum of 77mm (3in), and no bare aluminum surfaces are exposed.

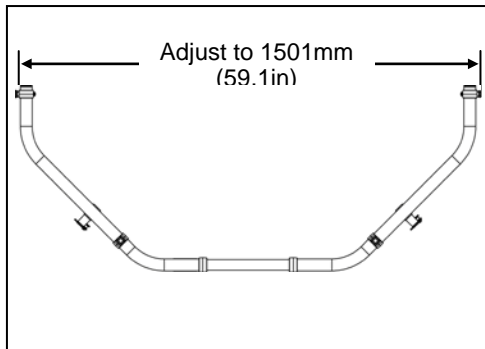

- 2) Adjust the Bed Extender width to about 1501mm (59.1in).

NOTE: Make sure no bare aluminum surfaces are exposed.

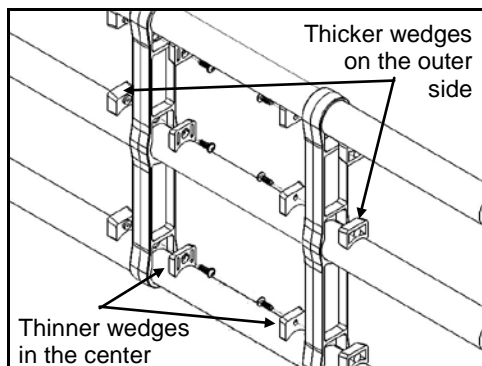

- 3) Using a T-20 Torx wrench, screw together the double wedges in the plastic upright cavity with the PT Screws as shown in the figure (double wedge thru-hole goes in the center and double wedge threaded goes on the outer side). Tighten to 2.3 N-m (20 in-lbf).

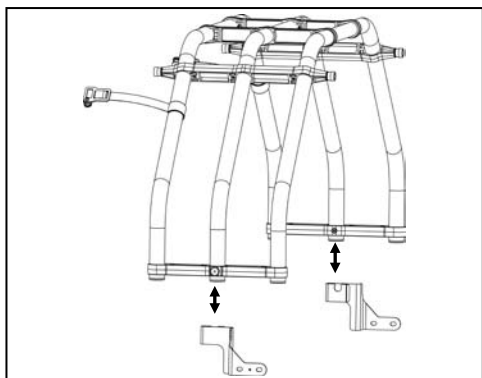

- 4) Lower the Bed Extender into the brackets by holding it in the vertical position. Also, have the Bed Extender in vertical position to remove from the brackets.

NOTE: It is normal for the Extender to have some resistance, when it is first rotated in the brackets.

INSTALLATION INSTRUCTIONS – TITAN TRUCK BED EXTENDER

9. BED EXTENDER USAGE POSITIONS.

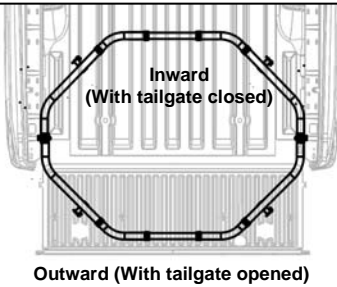

1) Two positions available for the Bed Extender:

- Bed Extender flipped inward with tailgate closed.
- Bed Extender flipped outward with tailgate opened.

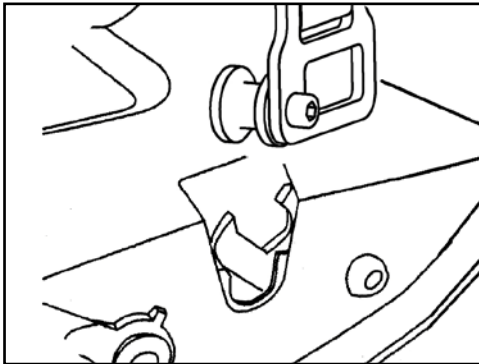

2) When the Bed Extender is at outward position, push down on the buckles to insert into tailgate latches. Tighten straps. To release, pull tailgate handle.

NOTE: Ensure that buckles are properly inserted into latches by pulling on the straps after both buckles have been inserted.